

PRODUCT DATA SHEET

F075-3V4 - 3" MECHANICAL FLOW METER WITH HEAVY DUTY MECHANICAL DISPLAY

The M Series 3" MECHANICAL FLOW METER are suitable for flows between 20 – 733 L/min (5.28 - 193.64 GPM), providing highly accurate flow measurement performance. The M Series offers $\pm 1.00\%$ accuracy of true reading in a compact footprint, requiring no flow conditioning and with high pressure and temperature capabilities.

Key features include:

- Cast Aluminium construction
- FKM (Viton) seals
- Maximum flow rate 733 L/min / 193.64 GPM
- Accuracy of $\pm 1.00\%$ of reading
- Exceptional repeatability of $\pm 0.03\%$
- Temperature up to 120 °C / 248 °F
- 1 point factory calibration as standard, with additional points upon request

SPECIFICATIONS



F075-3V4

	F075-3V4			
Material of construction	Meter Body	Cast Aluminium		
	Rotor	Aluminium (6061)		
	Seals	FKM (Viton)		
Design Specifications				
Process Connections		3" NPT Thread [w/ litres mech display]		
Technical Specifications		min	max	
	Flow rate < 5cPr	60	600	L/min
		15.85	158.50	GPM
	> 5cP	20	733	L/min
		5.28	193.64	GPM
	Non lubricating fluids	-	733	L/min
		-	193.64	GPM
	Operating Temperature Range**	-40	120	°C
		-40	248	°F
	Accuracy (±%)	1.00%		
	Repeatability (±%)	0.03%		
Nominal K-Factor	- Pulses/Litre			
	- Pulses/Gallon			

OUTPUT TYPE



HEAVY DUTY MECHANICAL DISPLAY

Heavy Duty Mechanical	
Construction	Aluminium
IP Rating	IP67
Temp	Min: - Max: - °C Min: - Max: - °F
EX Approvals	- Please refer to instruction manual and certification documentation for product appropriate certification information
Display	
Digit size (upper/lower)	17mm/6mm
Accumulated total	✓
Resettable total	✓
Preset total	✗
Flow rate	✗
Outputs	
4-20 mA (passive)	✗
Pulse/Transistor Output	✗
Flow Alarm	✗
Batch Control output	✗

PRODUCT DATA SHEET



F075-1S4
S075-1S4

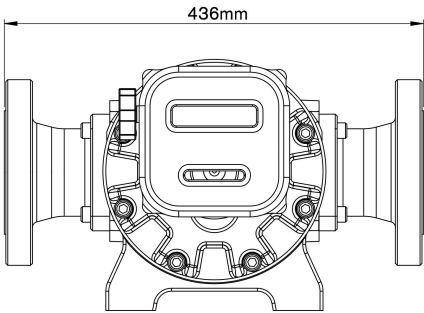
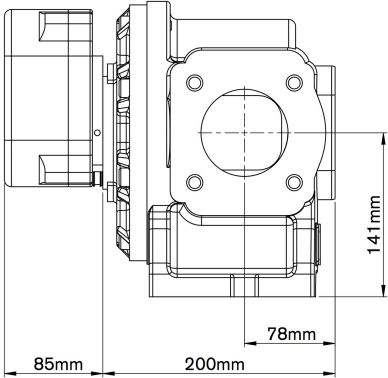
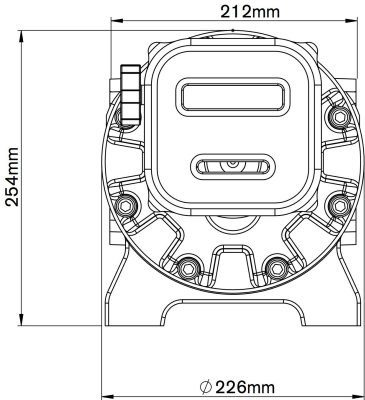

ANSI/DIN/JIS

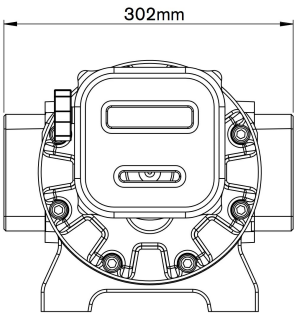

G/NPT